



SpencerFane

BECKY JOHNSON, PARALEGAL
PHONE: (303) 839-3885
bjohnson@spencerfane.com

File No. 5114923.0019

December 15, 2020

Division of Local Government
1313 Sherman Street, Room 521
Denver, Colorado

DLG E-Portal

Weld County Assessor
1400 N. 17th Avenue
Greeley, CO 80631

assessor@weldgov.com

Weld County Clerk and Recorder
1402 N. 17th Ave.
Greeley, CO 80631

ckoppes@weldgov.com

**Re: Waterfront at Foster Lake Metropolitan District Nos. 1-3
Boundary Map**

Dear Sir or Madam:

Pursuant to Section 32-1-306, C.R.S., attached to this correspondence is a current map of the boundaries of the above-referenced District.

Please do not hesitate to contact our office should you have any questions or require additional information.

Sincerely,

/s/ Becky Johnson

Becky Johnson, Paralegal

Encl.

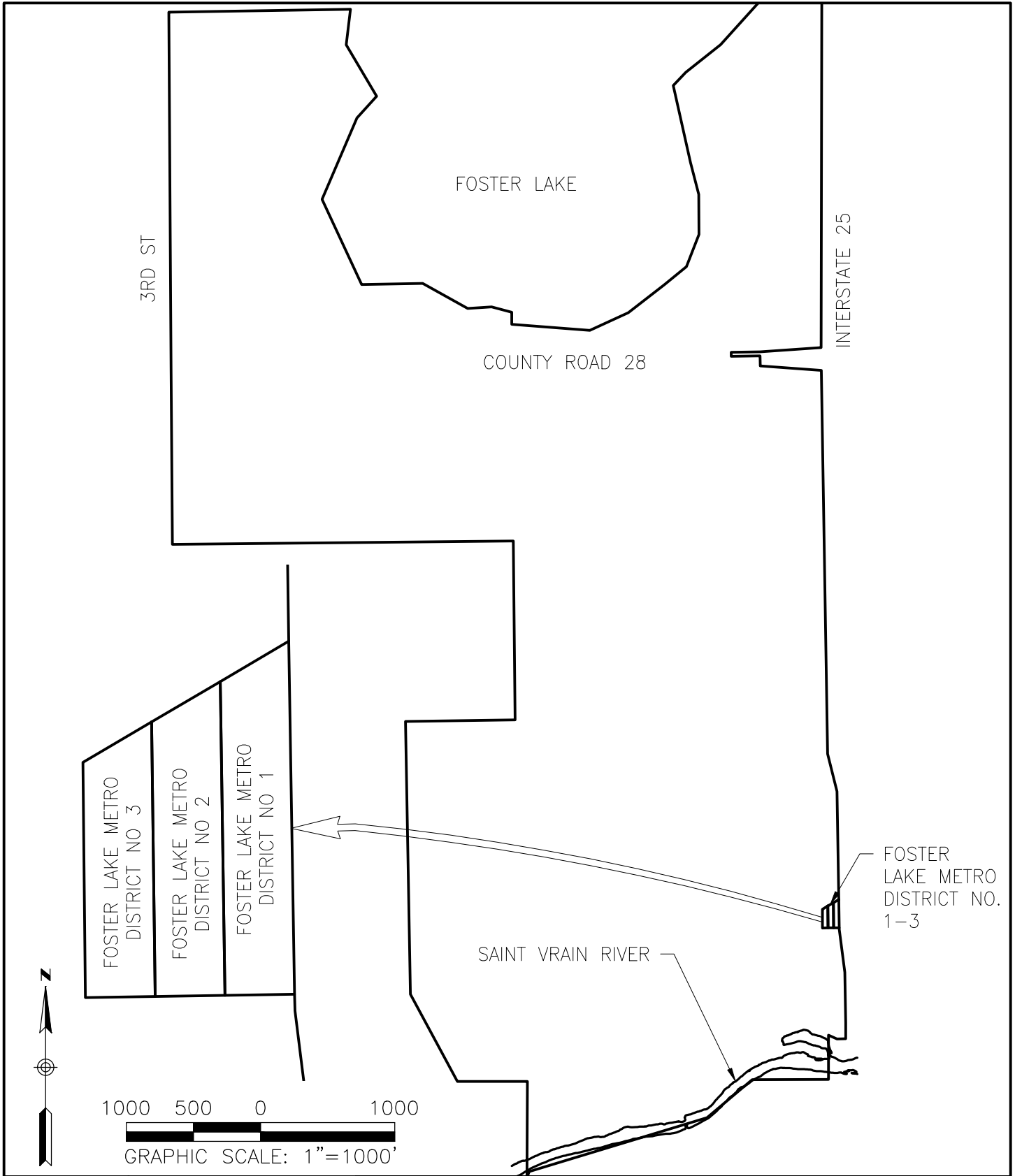

RICK
ENGINEERING COMPANY

9801 E EASTER AVE,
 CENTENNIAL, CO 80112
 PH. (303) 537-8020

TITLE: **FOSTER LAKE METRO DISTRICT LOCATION MAP**

SCALE: 1"=1000'	REVISED: 1.14.21	D01041
-----------------	------------------	--------